

DIMENSIONS

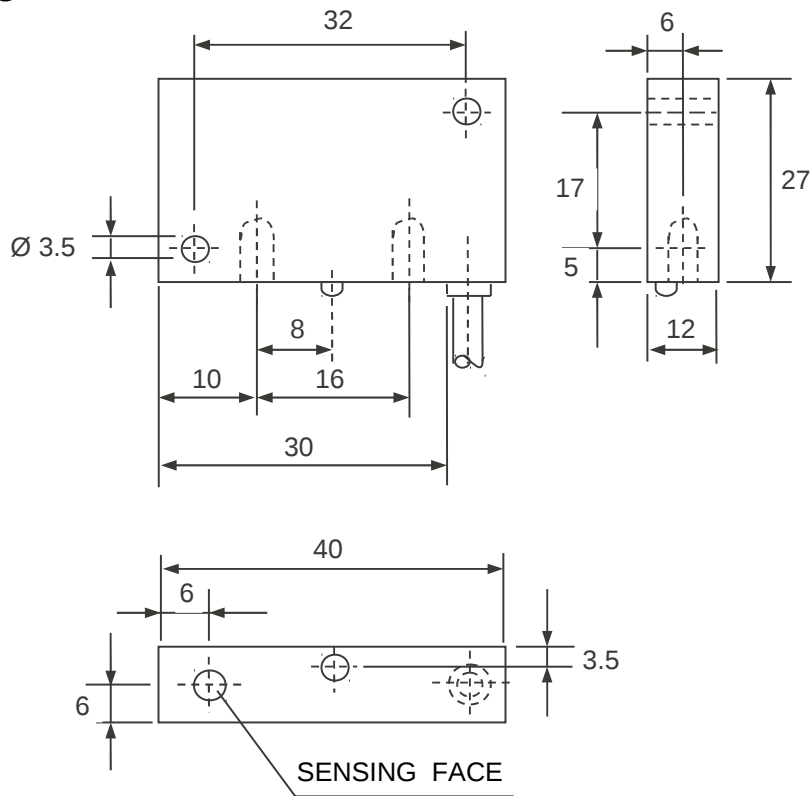

SPECIFICATIONS

1. Type	: NPN
2. Output	: N/O
3. Supply Voltage	: 5-30V DC
4. Current Consumption	: 15mA Max
5. Operating Distance	: 4.0 ± 0.4 mm
6. Hysteresis	: <10%
7. Voltage Drop	: 0.5V Max
8. Load Current	: 200mA Max
9. Repetition	: 250 Hz
10. Supply Voltage Drift	: ± 0.4 mm
11. Function Indication	: 3mm Red LED
12. Operating Temperature	: -20°C to 60°C
13. Housing	: Plastic
14. Standard Target	: 12x12x1 mm
15. Correction Factor	: $St=1, Br=0.5, Al=0.46, Cu=0.4$
16. Cable	: 3x0.3 sq.mm 2.5m length

WIRING DIAGRAM

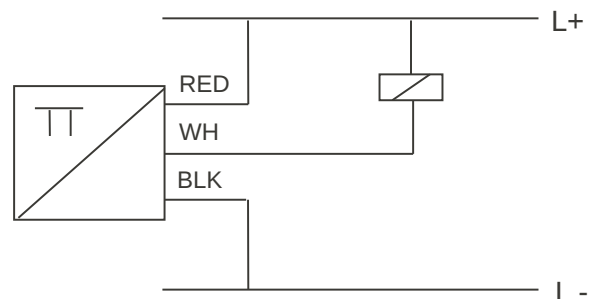

Magnum Controls
COIMBATORE

PROXIMITY SWITCH
MODEL : PK11DAN